

ST BEDE'S CATHOLIC COLLEGE

WASTE MANAGEMENT PLAN



APPLICABLE TO	Staff, students and parents
DOCUMENT OWNER	Principal
APPROVAL DATE	20 March 2018
APPROVED BY	Principal
SCHOOL ACTIONS	School Policy – Staff and parents are to ensure practices are consistent with this policy.
LAST REVIEW DATE/S	Not Applicable
NEXT REVIEW DATE	9 February 2019 or earlier pending changes to the building site
RELATED DOCUMENTS	St Bede's Work Health and Safety Policy

PURPOSE

St Bede's Catholic College is committed to the care of the environment and the responsible management of waste material. This policy outlines the procedures for the education of the community on the importance of responsible waste management. Included in this policy is an outline of the sorting and disposal of waste material, whilst ensuring the safety of all community members. In developing this policy, consideration has been given to the ongoing building project and a commitment to the Catholic teachings of stewardship.

Specific consideration has also been given to two other College policies:

- Work, Health & Safety
- Child Protection

DEFINITION

Waste separation is the process of identifying and responsibly managing waste.

UNDERLYING PRINCIPLES

The principles underlying waste management are:

- to educate students on the detrimental impact on the environment of the disposal of waste and the benefits of a commitment to recycling as a means of reducing this impact,
- to maintain safety standards during sorting, handling and collecting of waste material,
- to reduce the volume of waste volume,
- To reduce the cost of waste disposal

WHO MUST COMPLY WITH THIS POLICY

St Bede's Catholic College values the importance of the responsible management of waste material. By complying with this policy, a culture of responsible waste management can be developed. Therefore, this waste management plan policy applies to all staff, students and people on the school site. It is expected that parents/carers, grandparents and family members will support the school through role modelling responsible waste management.

PROCEDURES

Education

As a Catholic school, we are very committed to the concept of 'stewardship' which has scriptural support. Integrated into the curriculum, particularly into our Geography and well-being programs, is an emphasis on the adverse impact on the environment of waste disposal and the importance of reducing this impact through responsible waste management.

Actions

Included in lesson routines, particularly in homeroom time, is the placement of waste into the correct bin – recyclable and non-recyclable. Details of the facilities provided and actions followed for these categories are detailed below:

- (1)** Recyclable material: There are currently six 10 x 120L Recyclable Waste Bins in the outside area which will increase as the student population increases. In addition to placing non-recyclable material into these bins, non-recyclable material from the classrooms are emptied into these bins on a daily basis. Each classroom has a 32L bin for recycling. These bins

are emptied at least twice a week into a 3 square metre skip bin which is located in a non-utilised section of the car park that is an out of bounds area for students. This bin is emptied on a fortnightly basis.

- (2) Non-recyclable material:** There are currently six 10 x 120L General Waste Bins in the outside area which will increase as the student population increases. In addition to placing non-recyclable material into these bins, non-recyclable material from the classrooms are emptied into these bins on a daily basis. Each classroom has a 32L bin for recycling. These bins are emptied at least twice a week into a 3 square metre skip bin which is located in a non-utilised section of the car park that is an out of bounds area for students. This bin is emptied on a weekly basis.

The collection of both the recyclable and non-recyclable material will occur outside of school hours to minimise the risks to the community, with the general waste collected every Wednesday and the recycling fortnightly on a Thursday. The collection point is within the Staff Carpark Area (Kiss and Drop Zone) immediately opposite the entrance/exit driveway, which is the most accessible location for the collection of the large bins and the furthest most point away from the students. The diagram below shows the location of this in relation to the site.

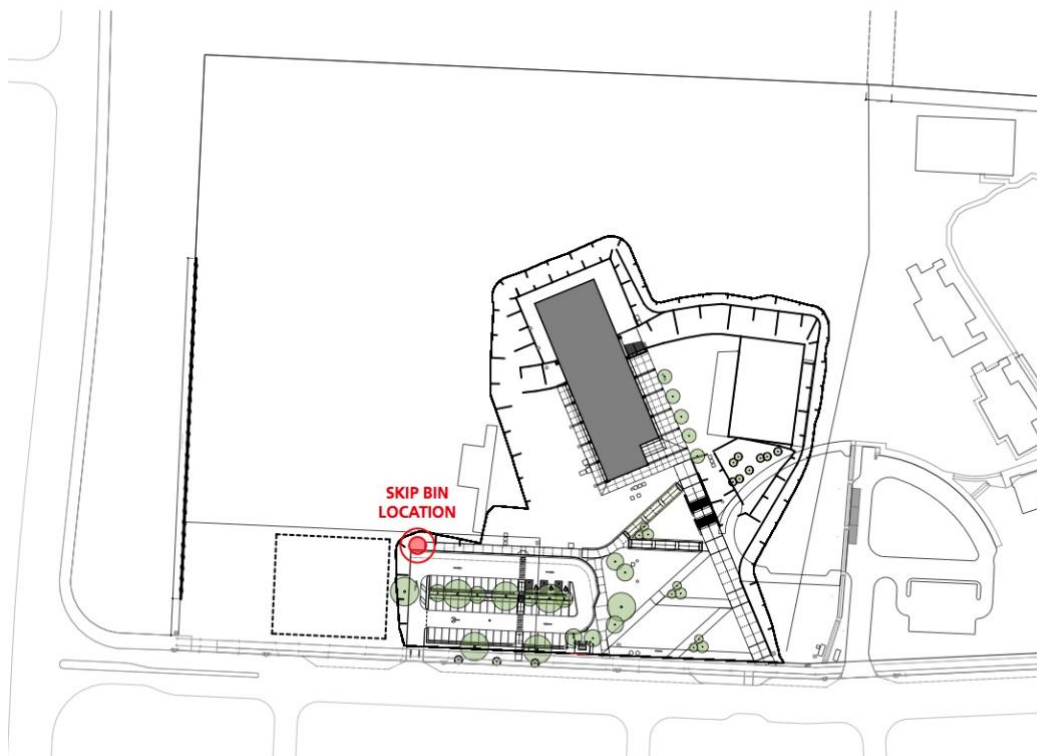

The College will continue to monitor the effectiveness of this plan and welcome any feedback on how it can be improved.